

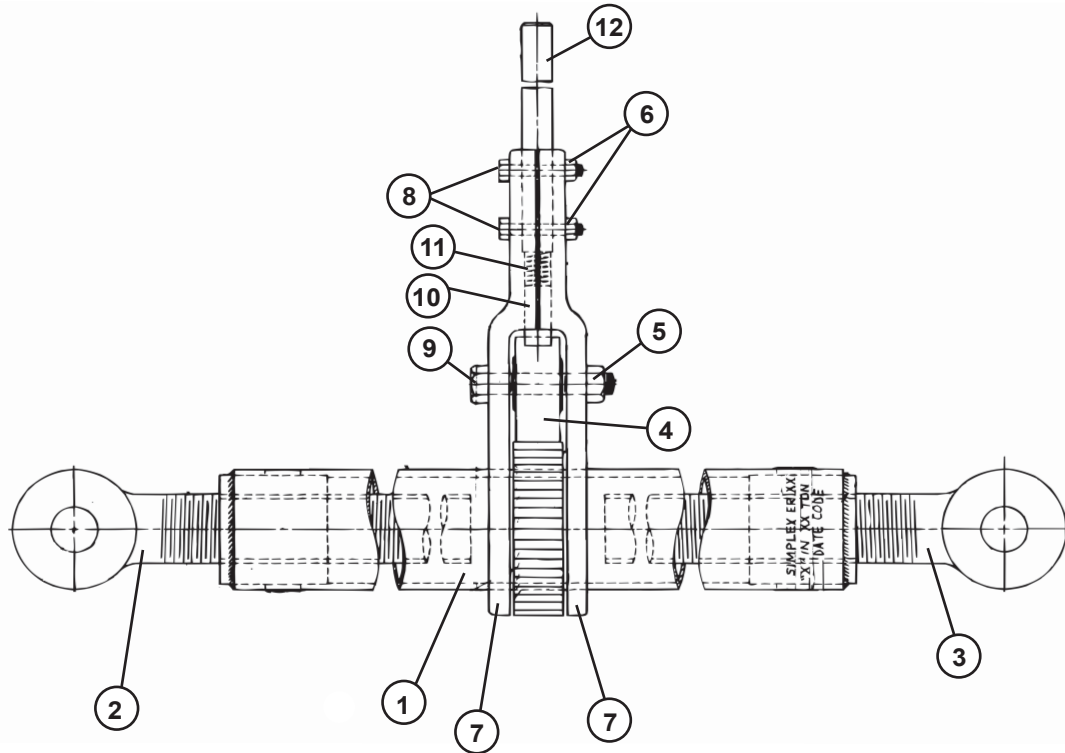

www.simplexmechanicals.com

SER10, SER20, SER30, SER40 LOADBINDER JACK REPAIR PARTS SHEET

Part Sheet # 54102
Revision - D
Date: 2_11



ITEM	DESCRIPTION	SER10	SER20	SER30	SER40	QTY
1	PIPE BARREL	91448	91557	91564	91451	1.00
2	SCREW (RIGHT HAND)	91452	91583	91584	91467	1.00
3	SCREW (LEFT HAND)	95265	95252	95254	95253	1.00
4	PAWL	91522	91522	91522	91522	1.00
5	HEX NUT	*	*	*	*	1.00
6	HEX NUT	*	*	*	*	2.00
7	SOCKET HALF	91548	91548	91548	91548	2.00
8	HHCS 5/16-18X2" LG	*	*	*	*	2.00
9	HHCS 5/8-11X3.25 LG	*	*	*	*	1.00
10	PLUNGER	●	●	●	●	1.00
11	PLUNGER SPRING	●	●	●	●	1.00
12	LEVER BAR	91525	91525	91525	91525	1.00
●	PLUNGER KIT COMPONENTS	RKER104001				
*	HARDWARE KIT COMPONENTS	RKER104002				

WARRANTY STATEMENT

Simplex products are warranted to be free of defects in materials and workmanship under normal use for as long as they are owned by the original purchaser, subject to the exclusions and limitations listed. This warranty does not cover ordinary normal wear & tear, abuse, overloading, alterations, (including repairs or attempted repairs by parties other than SIMPLEX or its Authorized Service Centers), improper fluid, or use in a manner for which they are not intended or use which is contrary to instructions for the products. If the customer believes a product is defective, the product must be delivered, or shipped freight prepaid, to the nearest SIMPLEX Authorized Service Center.