

Repair Parts Sheet	Revision	Revision Date	Product Code Beginning
Reference nr. L2819	Rev.A	04/2009	O

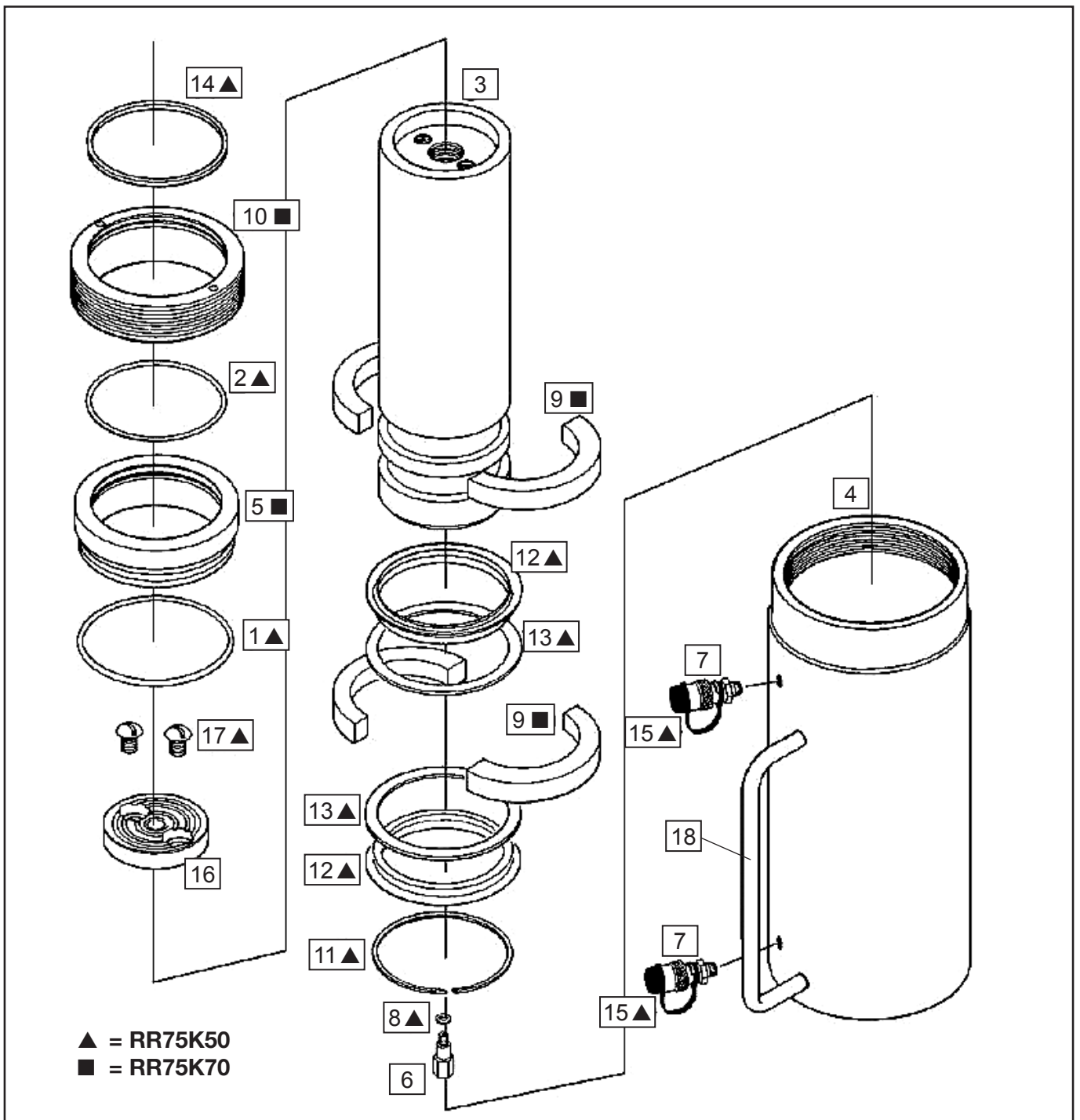

Repair Parts List				L 2819
Item	Description	Qty.	RR756	RR7513
1	O Ring	1	▲	▲
2	O Ring	1	▲	▲
3	Plunger	1	CB793040	CH912040
4	Base	1	Not available as service item, order new cylinder	
5	Internal Stop Ring	1	■	■
6	Safety Valve	1	G586900SR-7500	G586900SR-7500
7	Coupler	2	CR400	CR400
8	Gasket	1	▲	▲
9	Rod Bearing	2	■	■
10	Stop Ring	1	■	■
11	Retaining Ring	1	▲	▲
12	U Cup	2	▲	▲
13	Washer	2	▲	▲
14	Wiper	1	▲	▲
15	Dust Cap	2	▲	▲
16	Saddle (Incl.item 17)	1	L345045SR	L345045SR
17	Screw	2	▲	▲
18	Cylinder Handle Assy.	1		CL1054950SR
19	Coupler O Ring (not shown)	2	▲	▲
20	Warning Decal (not shown )	1	▲	▲
21	Enerpac Decal (not Shown)	2	▲	▲

- ▲ = Items included in and available only as part of Repair Kit RR75K50  
 ▲+■ = Items included in and available only as part of Repair Kit RR75K70 ( RR75K70 includes RR75K50)



Item	Torque / Remarks
7	34 - 81 Nm 25 - 60 ft lbs
7	Use teflon tape or Loctite 545
6	Torque 6.8 - 7.9 Nm 60 - 70 in lbs
6	Safety valve setting 483 - 552 Bar
10	Secure with Loctite 222
13	Install washer 13 with chamfer facing 9 and square edge to item 12



To maintain your warranty,  
 have your products inspected and repaired  
 by an authorised Enerpac Service Centre

[www.enerpac.com](http://www.enerpac.com)