

Repair Parts Sheet	Revision	Revision Date	Product Code Beginning
L3017	Rev. F	12/2021	B

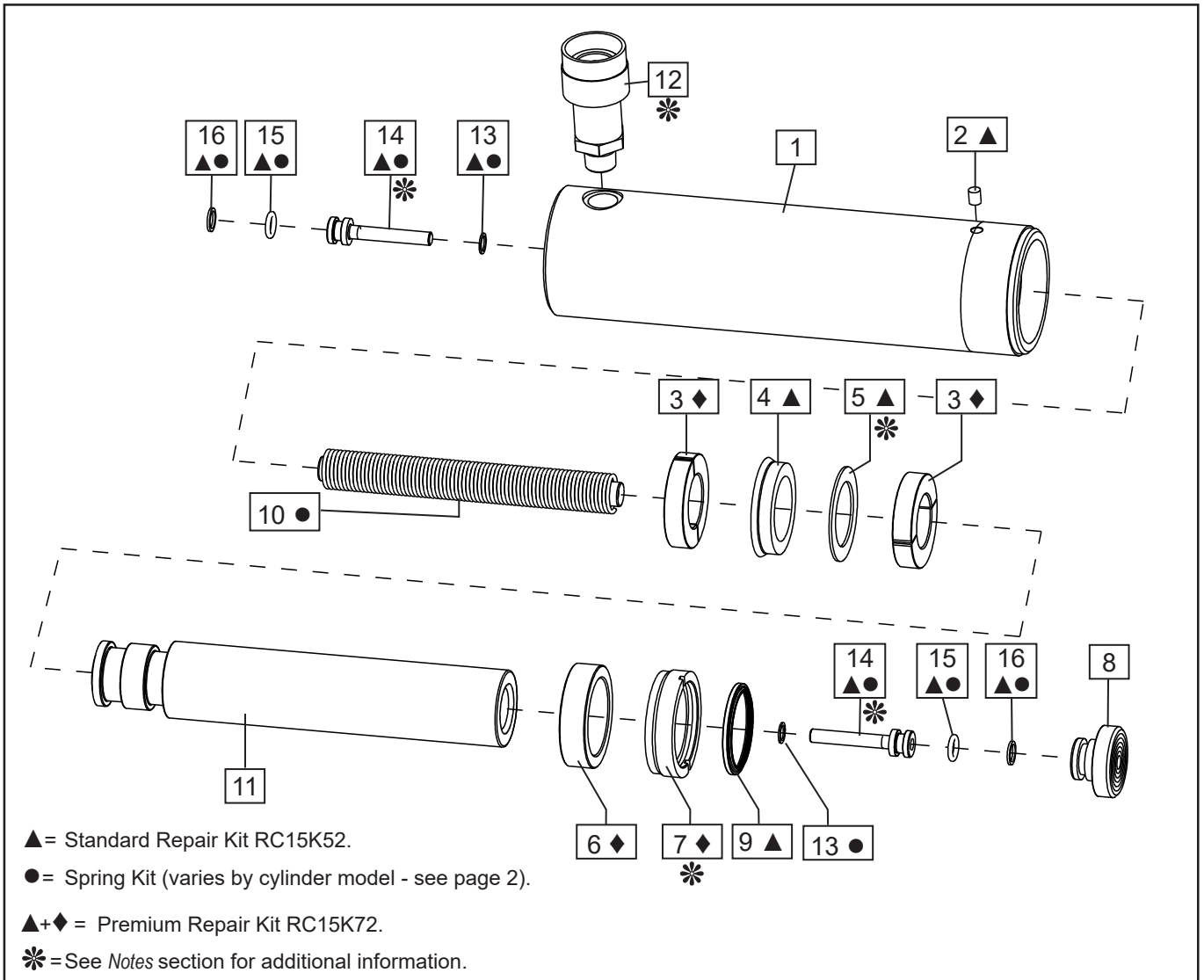

**Note: See Page 2
for parts list.**

(*) Notes	
Item	Torque / notes
5	Washer to be placed with the sharp edge towards U-Cup.
7	7.9 - 10.2 Nm, 70 - 90 In - Lbs
7	Secure with Loctite 222.
12	54 - 81 Nm, 40 - 60 Ft - Lbs
12	Use Loctite 545 or Teflon tape.
14	10.2 - 12.4 Nm, 90 - 110 In - Lbs

Repair Parts List, Figure 1

L3017

Item	Description	Qty.	Part Number				
			RC-156	RC-158	RC-1510	RC-1512	RC-1514
1	Base	1	(Not Available)	(Not Available)	(Not Available)	(Not Available)	(Not Available)
2	Filter ▲	1	PA1203118	PA1203118	PA1203118	PA1203118	PA1203118
3	Bearing ◆	2	DD2278107	DD2278107	DD2278107	DD2278107	DD2278107
4	U-Cup ▲	1	CF297041	CF297041	CF297041	CF297041	CF297041
5	Washer ▲	1	L231108	L231108	L231108	L231108	L231108
6	Bearing, Stop Ring ◆	1	CF293446	CF293446	CF293446	CF293446	CF293446
7	Stop Ring ◆	1	CF294044	CF294044	CF294044	CF294044	CF294044
8	Saddle, Grooved	1	A152G	A152G	A152G	A152G	A152G
9	Wiper Ring ▲	1	CF296044	CF296044	CF296044	CF296044	CF296044
10	Spring ●	1	DD2463110	DD2464110	DD2465110	DD2466110	DD2467110
11	Plunger	1	(Not Available)	(Not Available)	(Not Available)	(Not Available)	(Not Available)
12	Coupler	1	CR-400	CR-400	CR-400	CR-400	CR-400
13	Gasket ▲●	2	C846037	C846037	C846037	C846037	C846037
14	Spring Retainer ▲●	2	DD1543160	DD1543160	DD1543160	DD1543160	DD1543160
15	O-Ring ▲●	2	B1110903	B1110903	B1110903	B1110903	B1110903
16	Back-up ▲●	2	B1110564	B1110564	B1110564	B1110564	B1110564
N/S	Dust Cap ▲	1	DD1782020	DD1782020	DD1782020	DD1782020	DD1782020
N/S	Thread Protector ▲	1	DD1775271	DD1775271	DD1775271	DD1775271	DD1775271
N/S	O-Ring Coupler ▲	1	B1116803	B1116803	B1116803	B1116803	B1116803
N/S	Enerpac Decal ▲	1	DD2216026	DD2216026	DD2217026	DD2217026	DD2217026
N/S	Warning Decal ▲	1	DA5117026	DA5117026	DA5117026	DA5117026	DA5117026
N/S	O-Ring Saddle ▲	1	B1208503	B1208503	B1208503	B1208503	B1208503
▲	Repair Kit, Standard	-	RC15K52	RC15K52	RC15K52	RC15K52	RC15K52
◆ + ▲	Repair Kit, Premium	-	RC15K72	RC15K72	RC15K72	RC15K72	RC15K72
●	Spring Kit	-	RC15K33	RC15K34	RC15K35	RC15K36	RC15K37

Notes:

Premium repair kit includes all standard (▲) repair kit items plus additional premium (◆) items.
 N/S = Item not shown.
IMPORTANT: Shaded items are available only in kits (not sold separately).

Cylinders with Viton components only: Order Repair Kit RC156KV in addition to Repair Kit RC15K52 or RC15K72.
 Repair Kit RC156KV includes Viton components for items 4 and 9. Standard components are used in other locations.



To maintain your warranty:

- Use only Enerpac Oil
- Have your products inspected and repaired by an Enerpac Authorized Service Center



Visit www.enerpac.com for the location of the Enerpac Authorized Service Center nearest you.