

WHEELED MACHINE SKATES

MOVE AND POSITION LOADS UP TO 35 TONS



MLS-SERIES

ENERPAC 

▼ **MLS-Series, Wheeled Machine Skates**



DESIGNED FOR INDUSTRIAL MACHINE MOVERS AND MILLWRIGHTS

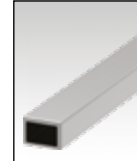

Connecting Bars

Connecting bars come standard with MLSD-models. Different lengths of connecting bars are available to connect MLSR-models together.

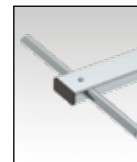

Handles

MLSF-models come standard with size-specific handles. Optional manual or pulling eye handles are available for MLSR-models.



Optional Turntable Assembly

Available for MLSR-Rotational Skates. The turntable provides an additional 1.45 inch of height.

- Durable polyurethane or optional nylon wheels provide excellent stability while preventing damage to finished floors
- Rugged, reliable bearings and wheels deliver low rolling resistance
- Low height requires minimal lifting to accommodate moves
- MLSF steerable skates improve maneuverability with turntables that can easily rotate under the load, ideal for general applications
- For ultimate versatility, MLSR rotational skates provide 360 degrees of directional movement, ideal for confined space applications
- Models pre-assembled with nylon wheels are available upon request
- Configure MLSR sets with a handle and connecting bar to meet your application requirements.



Nylon Wheel Kits

Nylon wheel kits are available for better wear resistance or if increased capacity is required.

Nylon Wheel Kit	Part Number	Compatible Skates	No. of Wheel Kits per Skate
ø 3.35 inch x 3.43 inch width. Includes 4 wheels	MLSWNY85874	MLSF3, MLSD3	1
		MLSF7, MLSD7	2
		MLSF10, MLSD10	3
		MLSF13, MLSD13	4
ø 5.51 inch x 3.35 inch width. Includes 4 wheels	MLSWNY140854	MLSF17, MLSD17	2
		MLSF27, MLSD27	3
		MLSF35, MLSD35	4

An Enerpac MLS-Series machine skate set combined with a low-height hydraulic cylinder provides the ideal package for heavy machinery moves. ▶





Selecting the Right Skate Set

MLS-Series Machine Skates offer easy and stable movement across various floor types.

MLSS-sets (consisting of MLSF and MLSD-skates) are a great option for most maneuvers, especially when confined space is not a concern.

MLSR-rotational skates have the highest level of maneuverability for easy moves in tight spaces and around corners.

Combining MLSS-models with connecting bars and handles provides a versatile set to cover more applications.

For ordinary concrete floors consider the ER-Series Chain Roller Machine Skates.

EMLS, EMV-Series, Battery-Powered Machine Skates

Remote-controlled, heavy-duty machine moving system up to 55 tons for clean and even surfaces.

MLS Series



Capacity (Individual Skates):

3.3 - 35.2 tons

Height:

4.3 - 7.0 inches

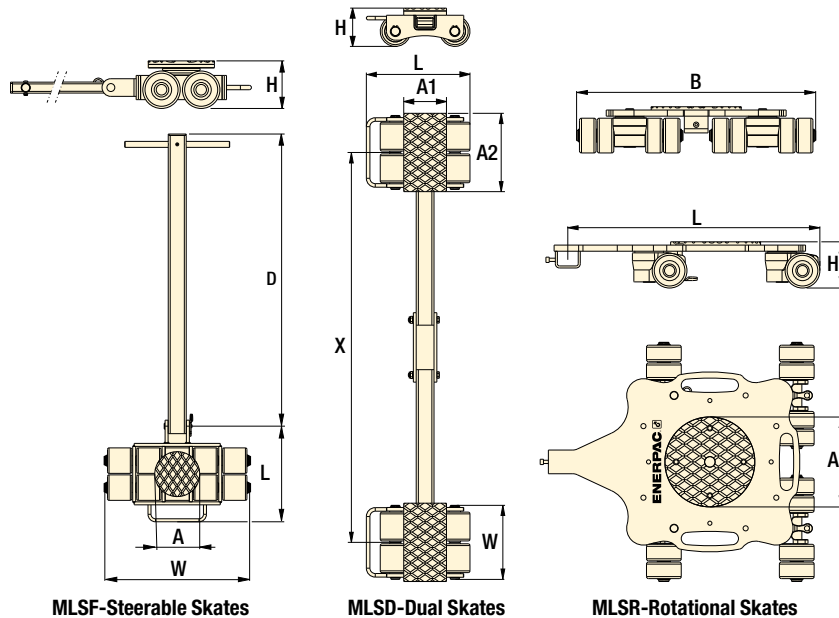

MLSF-Steerable Skates

MLSD-Dual Skates

MLSR-Rotational Skates

SELECTION CHART

Capacity (ton)	Model Number	No. of Wheels/ Diameter	Dimensions (inch)										Handle Type	Weight (lbs)
			ø inch	A	A1	A2	B	D	H	L	W	X		
3.3	MLSF3	4	3.35	5.8	-	-	-	39.0	4.3	9.3	10.4	-	Manual	30.8
6.6	MLSF7	8	3.35	5.8	-	-	-	39.0	4.3	13.2	18.8	-	Manual	57.3
9.9	MLSF10	12	3.35	6.6	-	-	-	45.6	4.3	20.6	30.4	-	Towable	125.6
13.2	MLSF13	16	3.35	6.6	-	-	-	45.6	4.3	20.7	38.3	-	Towable	149.9
17.6	MLSF17	8	5.51	8.6	-	-	-	63.8	7.0	22.1	28.2	-	Towable	291.0
26.4	MLSF27	12	5.51	8.6	-	-	-	63.8	7.0	22.1	36.3	-	Towable	348.3
35.2	MLSF35	16	5.51	9.7	-	-	-	63.8	7.0	22.1	45.0	-	Towable	432.1
3.3	MLSD3	4	3.35	-	5.9	2.9	-	4.3	9.7	4.7	4.7 - 39.3	-	-	30.9
6.6	MLSD7	8	3.35	-	4.7	8.7	-	4.3	11.5	8.7	16.5 - 43.3	-	-	63.9
9.9	MLSD10	12	3.35	-	6.7	7.1	-	4.3	11.6	11.6	18.1 - 45.0	-	-	79.4
13.2	MLSD13	16	3.35	-	7.9	8.7	-	4.3	11.5	15.0	22.0 - 43.1	-	-	99.2
17.6	MLSD17	8	5.51	-	12.5	7.5	-	7.0	17.9	8.5	8.7 - 76.4	-	-	202.8
26.4	MLSD27	12	5.51	-	12.5	11.2	-	7.0	17.9	12.3	12.6 - 76.4	-	-	262.3
35.2	MLSD35	16	5.51	-	12.5	15.0	-	7.0	17.9	16.1	16.5 - 65.4	-	-	335.1
3.3	MLSR3	8	3.35	6.7	-	-	18.4	-	4.3	23.1	-	-	-	77.0
6.6	MLSR7	16	3.35	8.6	-	-	23.0	-	4.3	25.6	-	-	-	94.6
8.8	MLSR9	20	3.35	8.6	-	-	30.9	-	4.3	32.6	-	-	-	129.8



Lifting Wedges & Machine Lifts

To place Machine Skates, the load must first be lifted. This can be done using the LW-Series Enerpac Lifting Wedge or SOH-Series Machine Lifts.



ER-Series, Chain Roller Skates

Enerpac has an alternative offering of steel chain roller style machine skates for moving loads up to 80 tons.

MLSR ACCESSORIES

Description	Model Number	Type	Length (ft)	Compatible with
Handles	MLSHRT	Manual	3.2	MLSR3
	MLSHRR	Towable	3.8	
Connecting Bars	MLSCR6	Rigid	6.5	MLSR7
	MLSCR8	Rigid	8.0	MLSR9
	MLSCRH8	Handle Joint	8.0	

AVAILABLE SETS

Set Model Number	Set Model Numbers Include:	Set Capacity * (ton)
MLSS7	1x MLSF3 + 1x MLSD3	6.6
MLSS13	1x MLSF7 + 1x MLSD7	13.2
MLSS20	1x MLSF10 + 1x MLSD10	19.8
MLSS27	1x MLSF13 + 1x MLSD13	26.4
MLSS35	1x MLSF17 + 1x MLSD17	35.3
MLSS53	1x MLSF27 + 1x MLSD27	52.9
MLSS70	1x MLSF35 + 1x MLSD35	70.6

* Set capacity assumed to be equally distributed across skates. Ensure each individual skate capacity is not exceeded.



THE RIGHT TOOL MAKES ALL THE DIFFERENCE

The large and heavy objects that our lifting and positioning products are designed to manage are all extremely valuable and often irreplaceable pieces of equipment. Control and safety is paramount, especially when distributing the load over multiple lifting points. To ensure that synchronisation is guaranteed, Enerpac offers a range of intelligent lifting systems. These complete your heavy lifting solution, allowing you to work in a safe, professional and efficient manner. We are passionate about solving your challenges, together.

ELITE TOOLS. FOR ELITE PROFESSIONALS.



Low-Height Cylinders,
RSM, RCS-Series



Mini-Lift Hydraulic Gantry,
ML-Series

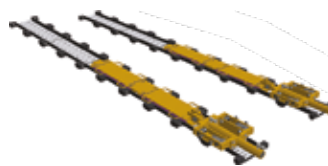

Skidding Systems,
LH, HSK-Series



Self-Locking Cube Jacks,
SCJ-Series

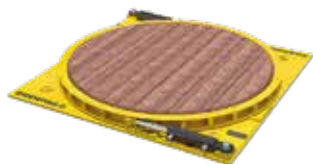

Hydraulic Turntables,
ETT-Series



Vertical Lifting Wedge,
LW-Series



Hydraulic Machine Lifts,
SOH-Series



Electric Trolley Systems,
ETR-Series



Steel Hand Pumps,
P-Series



Cordless Hydraulic Pumps,
ZC, XC-Series



Split-Flow Pumps,
SFP-Series



Battery-Powered Machine Skates,
EMLS, EMV-Series

ENERPAC 