

# STTC-Series, Safe T™ Torque Checker

**ENERPAC** 

## ▼ STTC2000 Safe T™ Torque Checker



### Safety & Accuracy

- Durable mobile testing device for Enerpac hydraulic torque wrench systems
- Delivering ultimate on site accuracy, testing the entire wrench, pump and hose system to be used on the job
- Consistent and repeatable  $\pm 1\%$  accurate range.

### Durability

- Durable splash-proof keypad and display for those harsh working environments
- Impact-resistant composite carry case.

### Simplicity

- Allows the user to validate & test the exact system (torque wrench, pump, hose, etc.) to give a digital read out in Ft.lbs or Nm
- Easy to operate: power up and start testing
- Transportable: all in one compact carry case, ideal for use on the road with its durable internal 3,6 V-2,2 Ah Lithium-ion battery.

### Versatility

- Can test all Enerpac S, W, RSL, HMT and DSX-Series wrenches of both square drive and hexagon cassettes up to 16.100 Ft.lbs (21.800 Nm)
- Hexagon Reducers or Square Drive Sockets to be bought separately.



Hexagon Reducer (nr. 9) must be bought separately: see selection tables on next page. ►

**Quick, simple and accurate mobile torque system safety testing device**



### Applications

All bolted joints from 144 Ft.lbs up to 16.100 Ft.lbs (195 - 21.800 Nm).

- All Enerpac torque wrenches up to the maximum capacity of the Torque Checker. Also for other brands that fit the envelope of the Torque Checker.
- Oil & Gas flanges,
- Tower Crane installation,
- Bigger machine installation/assembly,
- Wind Tower installation etc.

### Industries:

- Oil & Gas, Petrochemical,
- Wind Power Generation,
- Marine,
- Manufacturing,
- Mining, Rail and more.

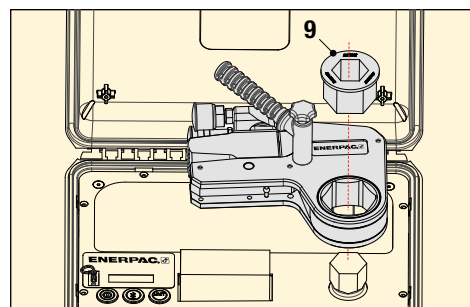
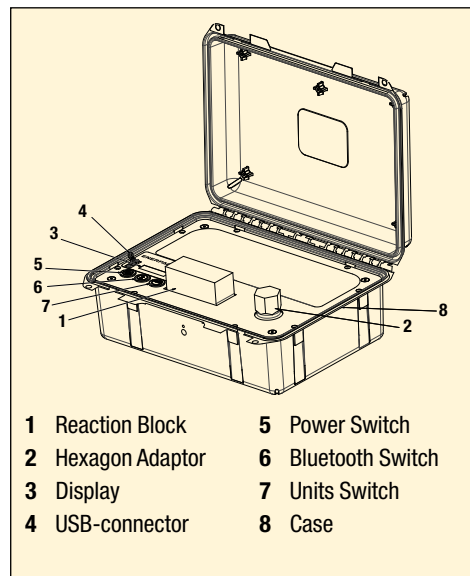

# Safe T™ Torque Checker



## Safe T™ Torque Checker

Mobile, compact safety device allows the end user to instantly validate the performance of the entire system to be used - not just the wrench only. Allows the user to test the system on-site and in situ.

The user can validate and test the exact torque system (wrench, pump, hose, etc) to give an accurate digital read out.

## Safety

The user can verify if the torque system is safe to operate, functioning correctly and within the desired safety parameters.

## Unique from Enerpac

No need to wait for annual calibration tests to be confident in the performance and safety of your equipment. The Safe T™ Torque Checker equipment can be validated in seconds, saving time and money.

## Hexagon Reducers

The W-Series Hexagon Reducers from the tables below, can be used with all W, RLP and HLP-Series hexagon cassettes.

## STTC Series



Max. Testing Output:

**16.100 Ft.lbs (21.800 Nm)**

Accuracy:

**± 1%**

Battery:

**3,6 V Lithium-ion**

For use with STTC2000					
Hexagon Size	Cassette Model Number	Hexagon Reducer to 1 1/16" (30 mm) Model Nr.			
(inch)	(mm)				
1 1/16	—	W2101X	-		
1 1/8	—	W2102X	-		
1 3/16	<b>30</b>	<b>W2103X</b>	*		
1 1/4	32	W2104X	**		
1 1/2	—	W2105X	**		
1 5/8	—	W2106X	W2106R103D		
1 3/4	36	W2107X	W2107R103D		
1 7/8	38	W2108X	W2108R103		
1 9/8	—	W2109X	W2109R103		
1 5/4	41	W2110X	W2110R103		
1 11/8	—	W2111X	W2111R103		
1 3/4	—	W2112X	W2112R103		
1 13/8	46	W2113X	W2113R103		
1 7/4	—	W2114X	W2114R103		
1 15/8	—	W2115X	W2115R103		
2	50	W2200X	W2200R103		
2 1/16	—	W2201X	W2201R103		
2 1/8	—	W2202X	W2202R103		
2 1/4	55	W2203X	W2203R103		
2 1/2	—	W2204X	W2204R103		
2 5/8	—	W2205X	W2205R103		
2 3/4	60	W2206X	W2206R103		

For use with STTC4000					
Hexagon Size	Cassette Model Number	Hexagon Reducer to 1 1/16" (36 mm) Model Nr.			
(inch)	(mm)				
1 5/16	—	W4105X	-		
1 3/8	—	W4106X	-		
1 7/8	<b>36</b>	<b>W4107X</b>	*		
1 1/2	—	W4108X	**		
1 9/8	—	W4109X	**		
1 5/4	41	W4110X	W4110R107		
1 11/8	—	W4111X	W4111R107		
1 3/4	—	W4112X	W4112R107		
1 13/8	46	W4113X	W4113R107		
1 7/4	—	W4114X	W4114R107		
1 15/8	—	W4115X	W4115R107		
2	50	W4200X	W4200R107		
2 1/16	—	W4201X	W4201R107		
2 1/8	—	W4202X	W4202R107		
2 1/4	55	W4203X	W4203R107		
2 1/2	—	W4204X	W4204R107		
2 5/8	—	W4205X	W4205R107		
2 3/4	60	W4206X	W4206R107		
2 7/8	—	W4207X	W4207R107		
2 11/8	—	W4208X	W4208R107		
2 5/4	65	W4209X	W4209R107		
2 3/2	—	W4210X	W4210R107		
2 13/8	—	W4211X	W4211R107		
2 3/4	70	W4212X	W4212R107		
2 15/8	—	W4213X	W4213R107		
2 7/4	—	W4214X	W4214R107		
2 17/8	75	W4215X	W4215R107		
3	—	W4300X	W4300R107		
3 1/16	—	W4301X	W4301R107		
3 1/8	80	W4302X	W4302R107		
3 1/4	—	W4303X	W4303R107		
3 1/2	—	W4304X	W4304R107		
3 3/8	—	W4305X	W4305R107		
3 3/4	—	W4306X	W4306R107		
—	85	W4085MX	W4085MR107		

For use with STTC8000					
Hexagon Size	Cassette Model Number	Hexagon Reducer to 2 inch (50 mm) Model Nr.			
(inch)	(mm)				
1 7/8	—	W8114X	-		
1 15/16	—	W8115X	-		
<b>2</b>	<b>50</b>	<b>W8200X</b>	*		
2 1/16	—	W8201X	**		
2 1/8	—	W8202X	**		
2 1/4	55	W8203X	W8203R200		
2 1/2	—	W8204X	W8204R200		
2 5/8	—	W8205X	W8205R200		
2 3/4	60	W8206X	W8206R200D		
2 7/8	—	W8207X	W8207R200		
2 11/8	—	W8208X	W8208R200		
2 5/4	65	W8209X	W8209R200		
2 3/2	—	W8210X	W8210R200		
2 13/8	—	W8211X	W8211R200		
2 3/4	70	W8212X	W8212R200		
2 15/8	—	W8213X	W8213R200		
2 7/4	—	W8214X	W8214R200		
2 17/8	75	W8215X	W8215R200		
3	—	W8300X	W8300R200		
3 1/16	—	W8301X	W8301R200		
3 1/8	80	W8302X	W8302R200		
3 1/4	—	W8303X	W8303R200		
3 1/2	—	W8304X	W8304R200		
3 3/8	—	W8305X	W8305R200		
—	85	W8085MX	W8085MR200		
3 3/4	—	W8306X	W8306R200		
3 7/8	—	W8307X	W8307R200		
3 15/8	—	W8308X	W8308R200		
—	90	W8090MX	W8090MR200		
3 3/2	—	W8309X	W8309R200		
3 13/8	—	W8310X	W8310R200		
3 3/4	—	W8311X	W8311R200		
3 3/2	95	W8312X	W8312R200		
3 17/8	—	W8313X	W8313R200		
3 7/4	—	W8314X	W8314R200		
3 15/4	100	W8315X	W8315R200		
4	—	W8400X	W8400R200		
4 1/16	—	W8401X	W8401R200		
4 1/8	105	W8402X	W8402R200		

For use with STTC15000					
Hexagon Size	Cassette Model Number	Hexagon Reducer to 2 5/8 inch Model Nr.			
(inch)	(mm)				
2 7/16	—	W15207X	-		
2 1/2	—	W15208X	-		
2 9/16	65	W15209X	-		
2 5/8	—	<b>W15210X</b>	*		
2 11/8	—	W15211X	**		
2 3/4	70	W15212X	**		
2 13/8	—	W15213X	**		
2 7/4	—	W15214X	W15214R210		
2 15/8	75	W15215X	W15215R210		
3	—	W15300X	W15300R210		
3 1/16	—	W15301X	W15301R210		
3 1/8	80	W15302X	W15302R210		
3 1/4	—	W15303X	W15303R210		
3 1/2	—	W15304X	W15304R210		
3 3/8	—	W15305X	W15305R210		
—	85	W15085MX	W15085MR210		
3 3/4	—	W15306X	W15306R210		
3 7/8	—	W15307X	W15307R210		
3 15/8	—	W15308X	W15308R210		
—	90	W15090MX	W15090MR210		
3 3/2	—	W15309X	W15309R210		
3 13/8	—	W15310X	W15310R210		
3 3/4	—	W15311X	W15311R210		
3 3/2	95	W15312X	W15312R210		
3 17/8	—	W15313X	W15313R210		
3 7/4	—	W15314X	W15314R210		
3 15/4	100	W15315X	W15315R210		
4	—	W15400X	W15400R210		
4 1/16	—	W15401X	W15401R210		
4 1/8	105	W15402X	W15402R210		
4 1/4	—	W15403X	W15403R210		
4 1/2	—	W15404X	W15404R210		
4 3/8	—	W15405X	W15405R210		
4 3/4	—	W15406X	W15406R210		
4 7/8	—	W15407X	W15407R210		
4 15/8	—	W15408X	W15408R210		
—	115	W15115MX	W15115MR210		
4 3/16	—	W15409X	W15409R210		
4 5/8	—	W15410X	W15410R210		



## Hexagon Reducers:

Must be bought separately. Can be used with all W, RLP and HLP-Series

hexagon cassettes.

\* Standard hexagon size of adaptor included with STTC-model

\*\* Requires special reaction block.

Nominal Measurable Torque Output		Model Number <sup>1)</sup>	Hexagon Adaptor included		Carry Case Size L x B x H		Sockets to be used with Square Drive Wrenches <sup>2)</sup>	Hexagon Cassette fits Adaptor. For other hexagon sizes, see table above with Hexagon Reducers sizes <sup>2)</sup>		
(Ft.lbs)	(Nm)		(inch)	(mm)				W-Series	RSL-Series	HMT-Series
2140	2900	<b>STTC2000</b>	1 3/16	30	414 x 328 x 328	6	BSH7530	W2103X	RLP1103	HLP1103
4383	5950	<b>STTC4000</b>	1 7/16	36	414 x 328 x 328	8	BSH1036	W4107X	RLP3107	HLP3107
8893	12.000	<b>STT 8000</b>	2	50	624 x 498 x 168	19	BSH1550	W8200X	RLP5200	HLP3200
16.100	21.800	<b>STTC15000</b>	2 5/8	—	624 x 498 x 168	26	BSH15263	W15210X	RLP8210	HLP7210

<sup>1)</sup> With 3,6 V-2,2 Ah Lithium-ion battery.

<sup>2)</sup> Square drive sockets, hexagon cassettes and hexagon reducers must be bought separately.